

JACK SCREWS

- Equivalent to AMP, CANNON & TRW Jack Screws
- "D" subminiature connector mounting screw
- Custom lengths available
- Hardware supplied unassembled and in bulk

SPECIFICATIONS: **YELLOW:** Steel, Zinc Plate and Yellow Chromate; **CLEAR:** Steel, Zinc Plate and Clear Chromate; **STAINLESS:** Stainless Steel

STANDARD JACK SCREWS

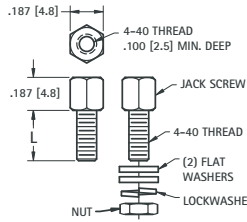

JACK ONLY			L LENGTH	JACK WITH HARDWARE*		
YELLOW CAT. NO.	CLEAR CAT. NO.	STAINLESS CAT. NO.		YELLOW CAT. NO.	CLEAR CAT. NO.	STAINLESS CAT. NO.
7226	7226-5	7246	.187 (4.8)	7227	7227-5	7247
7228	7228-5	7248	.250 (6.4)	7229	7229-5	7249
7230	7230-5	7250	.312 (7.9)	7231	7231-5	7251
7241	7241-5	7252	.375 (9.5)	7242	7242-5	7253
7243	7243-5	7254	.500 (12.7)	7244	7244-5	7255
7232	7232-5	7256	.625 (15.9)	7233	7233-5	7257

*Hardware supplied unassembled in bulk

SEMS JACK SCREWS

- Captivated helical spring lockwasher, simplifies use

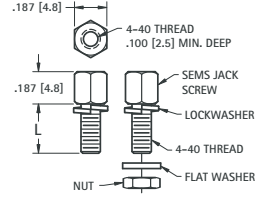

SEMS JACK ONLY		L LENGTH	SEMS JACK WITH HARDWARE*	
CLEAR CAT. NO.	LENGTH		CLEAR CAT. NO.	
7235	.285 (7.2)	7236		
7237	.347 (8.8)	7238		
7239	.660 (16.8)	7240		

*Hardware supplied unassembled in bulk

SLOTTED JACK SCREWS

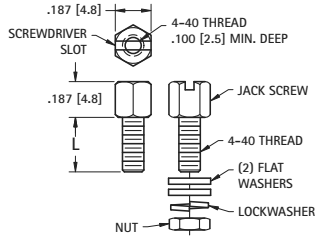

- Slot provides ability to install jack with a screwdriver.

JACK ONLY			L LENGTH	JACK WITH HARDWARE*	
YELLOW CAT. NO.	CLEAR CAT. NO.	YELLOW CAT. NO.		CLEAR CAT. NO.	
7270	7275	.250 (6.4)	7290	7295	
7271	7276	.312 (7.9)	7291	7296	
7272	7277	.375 (9.5)	7292	7297	
7273	7278	.500 (12.7)	7293	7298	
7274	7279	.625 (15.9)	7294	7299	

*Hardware supplied unassembled in bulk

JACK SCREWS WITH NYLON PATCH

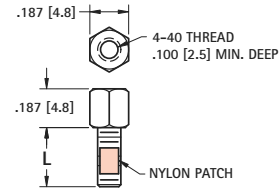

- Nylon patch holds jack firmly in vibration applications.

JACK WITH NYLON PATCH			
YELLOW CAT. NO.	CLEAR CAT. NO.	STAINLESS CAT. NO.	L LENGTH
7260	7261	7262	.250 (6.4)
7263	7264	7265	.312 (7.9)
7266	7267	7268	.375 (9.5)

TURNABLE JACK SCREWS

DIRECT ACCESS

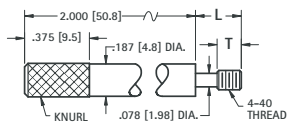

MATERIAL: Steel, Black Oxide

WITHOUT SLOT CAT. NO.	WITH SLOT CAT. NO.	T DIM.	L DIM.
2064	2065	.125 (3.2)	.250 (6.4)
2066	2067	.250 (6.4)	.437 (11.1)

STRAIGHT KNURL

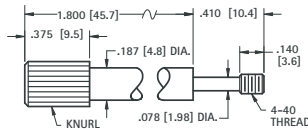

MATERIAL: Steel, Zinc Plate & Clear Chromate

WITHOUT SLOT CAT. NO.	WITH SLOT CAT. NO.
2072	2073

SLIM-LINE

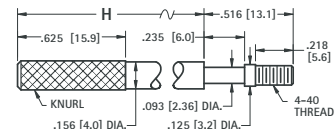

MATERIAL: Steel, Nickel Plate

WITHOUT SLOT CAT. NO.	WITH SLOT CAT. NO.	H DIM.
2068	2069	1.250 (31.8)
2070	2071	1.750 (44.5)

PANEL MOUNTING HARDWARE

"U" CLIP



Supplied Unassembled

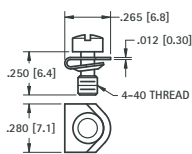

MATERIAL:
Clip & Screw: Steel, Zinc Plate & Yellow Chromate

CAT. NO. 2062

"BOW TIE" RETAINING CLIP



Supplied Unassembled

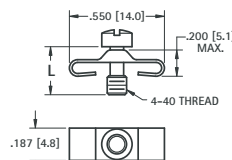

MATERIAL:
Clip & Screw: Steel, Zinc Plate & Yellow Chromate

CAT. NO.	L
2060	.250 (6.4)
2061	.281 (7.1)

SADDLE WASHER



Supplied Unassembled

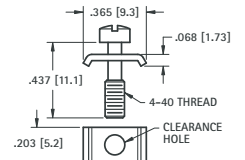

MATERIAL:
Clip & Screw: Steel, Zinc Plate & Yellow Chromate

CAT. NO. 2063