

Refer to pages 54-56 for Fuse Clip Layout and Mounting Details

### 1AG, 3AG, 7AG, 8AG THRU HOLE MOUNT TYPES

#### WITH SNAP-IN PC LEGS



**MATERIAL:**  
.020 (.51) Brass, Tin Plate  
**UL Current Rating:** 15 Amps

**CAT. NO. 3513**

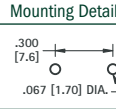
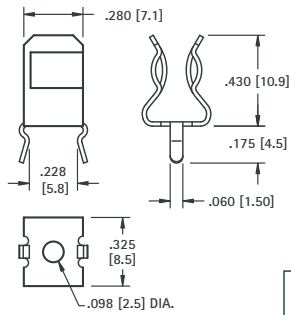

#### WITH SNAP-IN PC LEGS

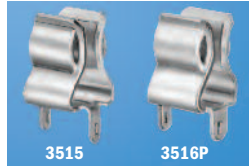

**MATERIAL:**  
.020 (.51) Brass, Tin Plate  
**UL Current Rating:** 15 Amps

CAT. NO.	A	B
3515	.060 (1.5)	.060 (1.5)
3515P	.060 (1.5)	.093 (2.4)
3516P	.060 (1.5)	.120 (3.0)

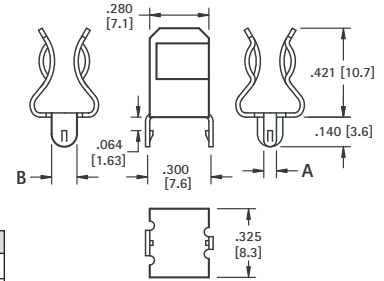

With or Without Orientation Legs

#### WITH STRAIGHT PC LEGS



**MATERIAL:**  
.020 (.51) Brass, Tin Plate  
**UL Current Rating:** 15 Amps

**CAT. NO. 3530**

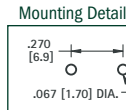
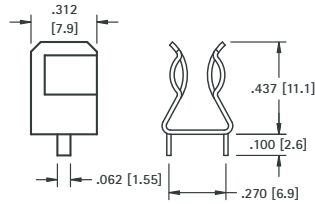

#### WITH STRAIGHT PC LEGS

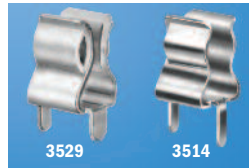

**MATERIAL:**  
.020 (.51) Brass, Tin Plate  
**UL Current Rating:** 15 Amps

CAT. NO.	H	L	END STOPS
3510	.421 (10.7)	.140 (3.6)	NO*
3529	.421 (10.7)	.140 (3.6)	YES
3511	.430 (10.9)	.250 (6.4)	NO*
3514	.430 (10.9)	.250 (6.4)	YES

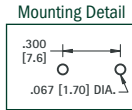
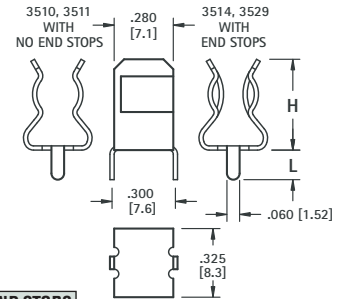

#### SNAP-IN WITH END STOP



**MATERIAL:**  
.020 (.51) Brass, Nickel Plate  
**UL Current Rating:** 20 Amps

**CAT. NO. 3500**

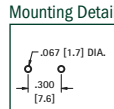
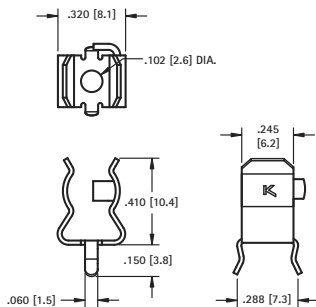

#### SMT & RIVET MOUNT, LOW PROFILE



**MATERIAL:**  
.020 (.51) Brass, Nickel Plate  
**UL Current Rating:** 15 Amps

**CAT. NO. 3531** (Without End Stops)\*

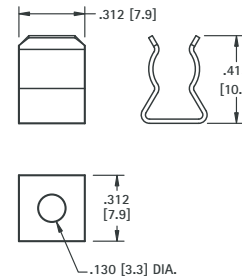

#### SMT & RIVET MOUNT WITH LUG



**MATERIAL:**  
.020 (.51) Brass, Nickel Plate  
**Current Rating:** 15 Amps

CAT. NO.	A	B
3533	Flat	.656 (16.7)
3535	45°	.562 (14.3)
3570	-	NO TAB

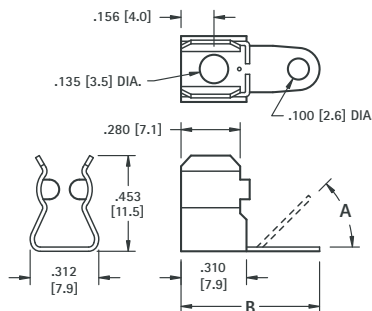

#### SMT & RIVET MOUNT

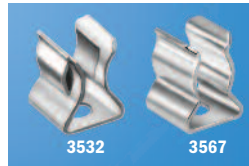

**MATERIAL:**  
.020 (.51) Brass, Nickel Plate  
**UL Current Rating:** 15 Amps

CAT. NO.	END STOPS
3532	YES
3567	NO*

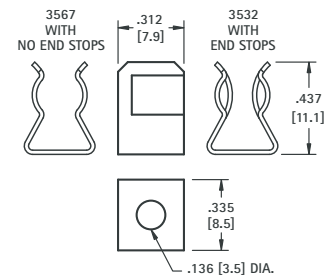

\*Fuse clips without end stops are not UL recognized