

SMT "AUTO" BLADE FUSE HOLDERS

- Compatible with most vacuum and mechanical pick and place assembly systems
- Fully insulated clips to protect fuses against shorting
- One piece assembly reduces assembly time
- Withstands shock and vibration

SPECIFICATIONS

Contacts: .016 (.41) Brass, Matte Tin Plate
Insulator: High Temperature Nylon 46, UL 94V-0
UL Temperature Rating: -58°F to +292°F (-50°C to +145°C)
UL Current Rating: 20 Amps @ 500V AC

AVAILABLE ON TAPE AND REEL



2 in 1 FUSE HOLDER

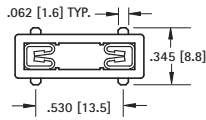

For Low Profile:
Littelfuse: 891 series/
Bussmann ATM-LP series

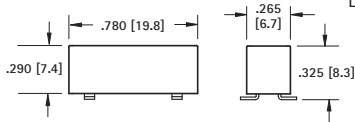

For Standard: Littelfuse:
ATOF series/ Bussmann
ATC series.

MINI FUSE HOLDER

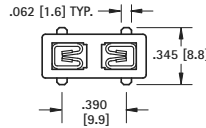

For Mini: Littelfuse:
MIN series/Bussmann
ATM series or equivalent

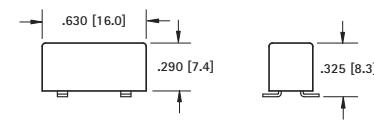

CAT. NO. BULK	ON TAPE & REEL	COLOR	FUSE REF.
3587	3587TR	Black	-
3587-10	3587-10TR	Red	10 Amp
3587-15	3587-15TR	Blue	15 Amp
3587-20	3587-20TR	Yellow	20 Amp

All colors UL rated for 20 Amp.

Tape & Reel Spec's: 32mm wide, 16mm pitch,
13 inch reel (500 pieces per reel)

Mounting Detail

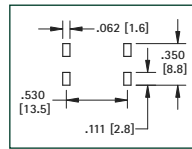

Mounting Detail

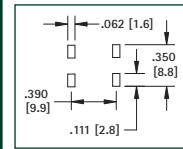

CAT. NO. BULK	ON TAPE & REEL	COLOR	FUSE REF.
3588	3588TR	Black	-
3588-10	3588-10TR	Red	10 Amp
3588-15	3588-15TR	Blue	15 Amp
3588-20	3588-20TR	Yellow	20 Amp

All colors UL rated for 20 Amp.

Tape & Reel Spec's: 32mm wide, 16mm pitch,
13 inch reel (500 pieces per reel)

SMT "AUTO" BLADE FUSE CLIPS

- Compatible with most vacuum and mechanical pick and place assembly systems
- KTR parts have Kapton Tape added to top service for vacuum pick & place

- Accepts Standard and Mini blade Automotive blade fuses
- Clip with Matte-Tin plate is ideal for low temperature soldering applications, for other temperature sensitive components

- Clips with Tin-Nickel plate are ideal for lead free, high temperature soldering applications

AVAILABLE ON TAPE AND REEL

VERTICAL ENTRY



For Mini: Littelfuse: MIN series/Bussmann ATM series.
For Standard: Littelfuse: ATOF series/Bussmann ATC series.
For Low Profile: Littelfuse: 891 series/Bussmann ATM-LP series

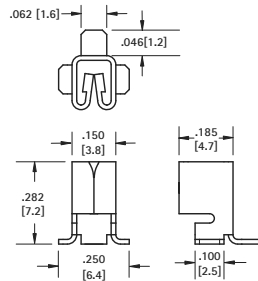

Pad Layout For Two Clips

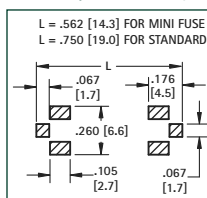

SPECIFICATIONS

Material: .016 (.41) Brass,
Tin-Nickel Plate
UL Current Rating:
30 Amps @ 500V AC

CAT. NO. 3586 (Bulk)

CAT. NO. 3586KTR (Tape & Reel)

Tape & Reel Spec's: 16mm wide, 12mm pitch,
13 inch reel (750 pieces per reel)

Pad Layout For Two Clips

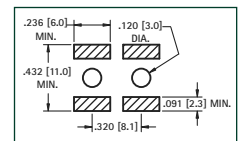

VERTICAL ENTRY



For Mini: Littelfuse: MIN series/Bussmann ATM series or equivalent

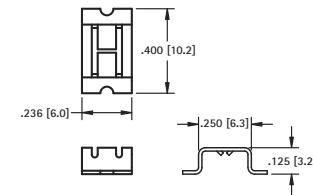

SPECIFICATIONS

Material: .016 (.41) Brass,
Matte Tin Plate
UL Current Rating: 15 Amps @ 500V AC

CAT. NO. 3583

CAT. NO. 3583KTR (Tape & Reel)

Tape & Reel Spec's: 24mm wide, 12mm pitch,
13 inch reel (1500 pieces per reel)

VERTICAL ENTRY



For Mini: Littelfuse: MIN series/Bussmann ATM series.
For Standard: Littelfuse: ATOF series/Bussmann ATC series.
For Low Profile: Littelfuse: 891 series/Bussmann ATM-LP series

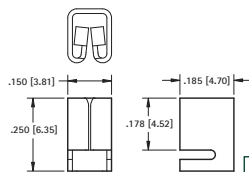

Pad Layout For Two Clips

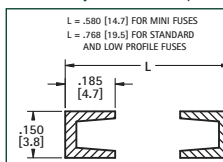

SPECIFICATIONS

Material: .018 (.41) Brass,
Tin-Nickel Plate
UL Current Rating: 30 Amps @ 500V AC

CAT. NO. 3584* (Bulk)

CAT. NO. 3584KTR* (Tape & Reel)

Tape & Reel Spec's: 16mm wide, 12mm pitch,
13 inch reel (750 pieces per reel)

* Cat. No. 3584 is not UL Listed

HORIZONTAL ENTRY

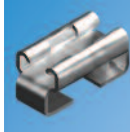

For Mini: Littelfuse: MIN series/
Bussmann ATM series or equivalent

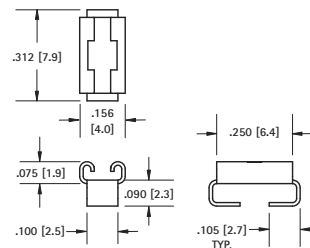

Mounting Detail For Two Clips

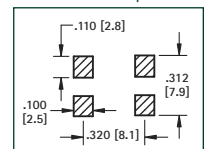

SPECIFICATIONS

Material: .012 (.30)
Brass, Matte Tin Plate
UL Current Rating:
20 Amps @ 500V AC

CAT. NO. 3569 (Bulk)

CAT. NO. 3569TR (Tape & Reel)

Tape & Reel Spec's: 24mm wide, 8mm pitch, 13 inch reel (1000 pieces per reel)