

SNAP-ON COIL SPRING CONTACTS

- Ideal for applications that have a self contained battery compartment
- Coil Springs will rebound after drop
- Reliable tension against battery help to assure low contact assistance

- Sharp barbs securely anchor contact in place
- Clips easily over .060 (1.5) to 0.70 (1.8) wall
- Long spring will accommodate variations in battery lengths



MATERIAL: Steel, Nickel Plate

Refer to page 42 for Battery Contact Layout & Mounting Details

“AAA”

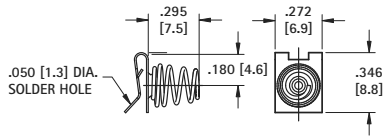

CAT. NO. 267

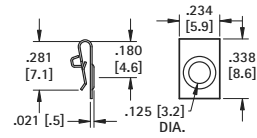

CAT. NO. 238

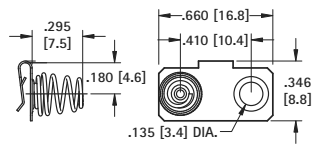

CAT. NO. 299

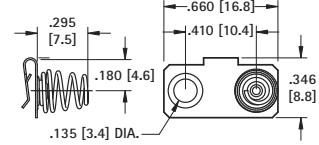

CAT. NO. 287

“AA”

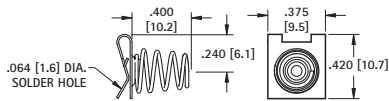

CAT. NO. 289

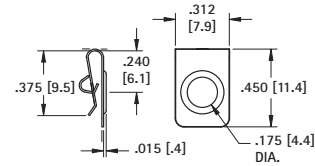

CAT. NO. 228

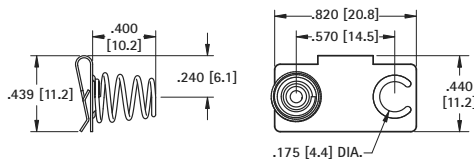

CAT. NO. 297

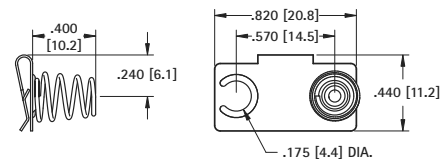

CAT. NO. 293

SLIDE-IN MOUNT CONTACTS

“AA” - “CR2” - “A” - “9V” - “17500” - “18350” - “18650”

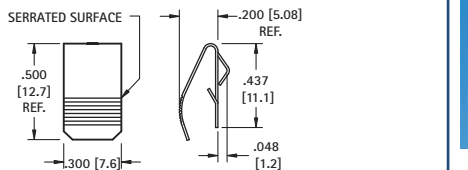

CAT. NO. 5205

MATERIAL: .012 (.30) Spring Steel, Nickel Plate

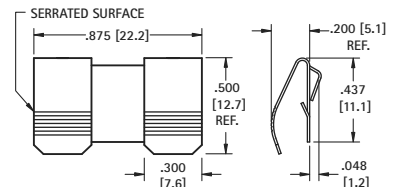
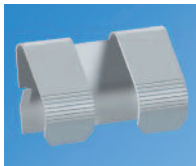

CAT. NO. 5208

MATERIAL: .012 (.30) Spring Steel, Nickel Plate

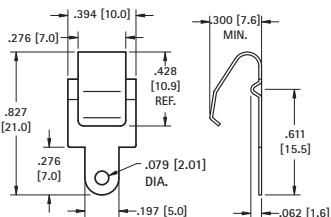

CAT. NO. 5209

MATERIAL: .012 (.30) Phosphor Bronze, Nickel Plate

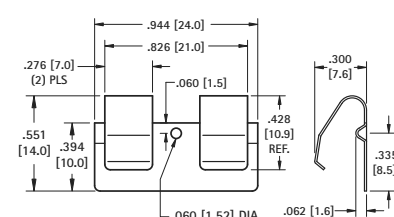

CAT. NO. 5208

MATERIAL: .012 (.30) Phosphor Bronze, Nickel Plate