

THIS DOCUMENT IS THE PROPERTY OF KEYSTONE ELECTRONICS CORP. AND SHALL NOT BE REPRODUCED, DISTRIBUTED OR USED AS A BASIS FOR MANUFACTURE WITHOUT PRIOR WRITTEN PERMISSION FROM KEYSTONE ELECTRONICS CORP.

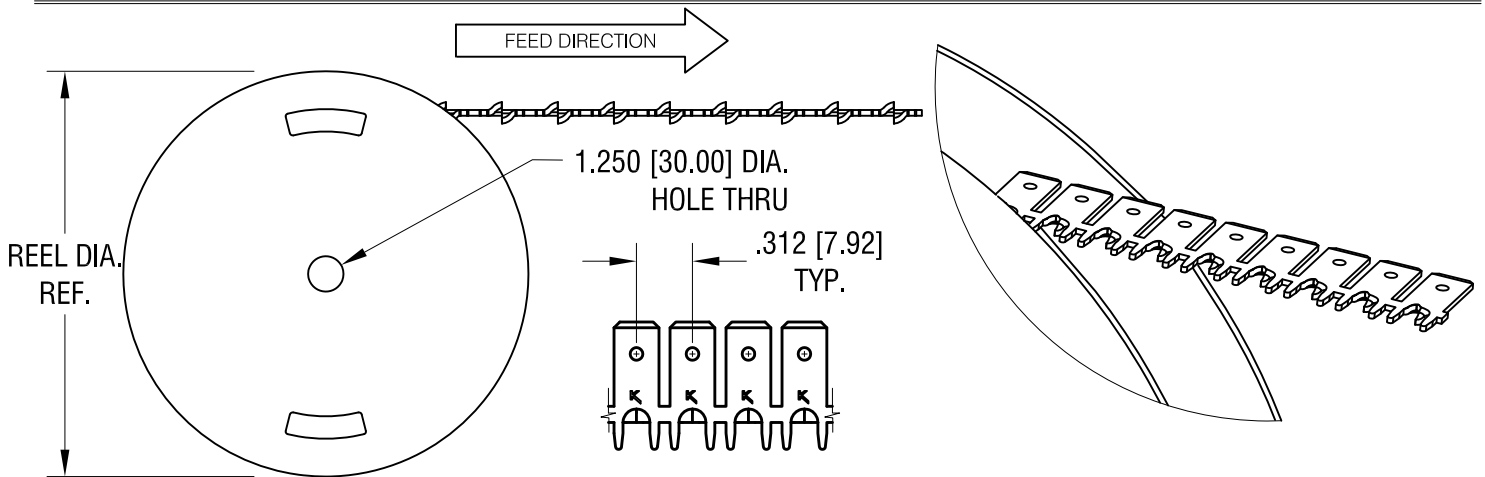
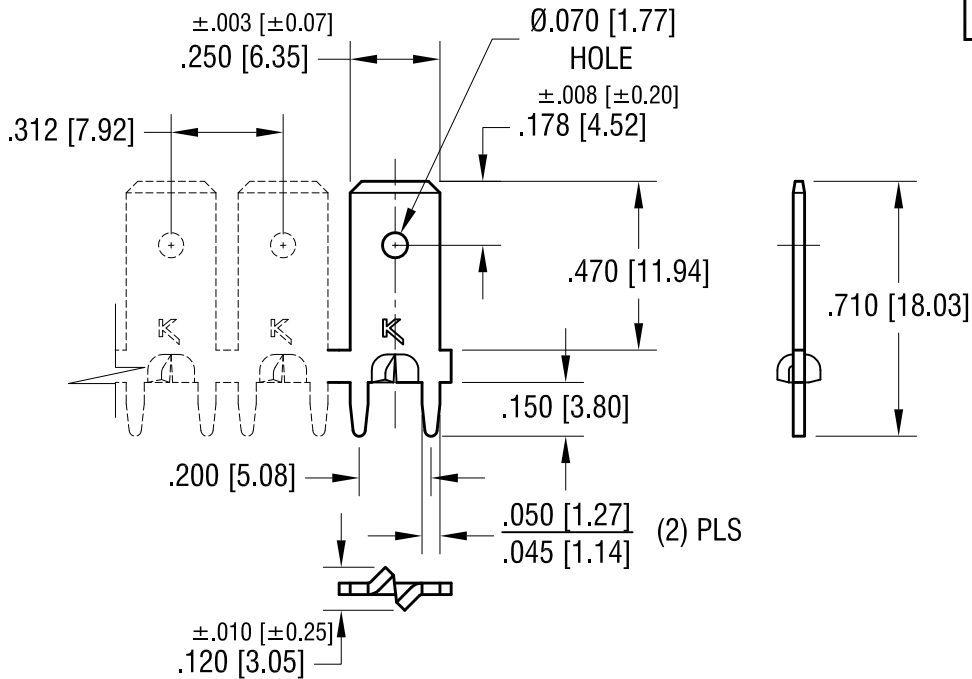

NOTES:

REEL SPECIFICATIONS:

1. REEL: MAT'L- CARDBOARD
24.0 [609.2] DIA. 10,000 PIECES PER CONTINUOUS REEL.

TERMINAL SPECIFICATIONS:

1. MAT'L- .032 [0.81] BRASS
2. FINISH: MATTE TIN PLATE.

| | | |
|----------|---|------|
| 11.02.22 | FLIP PARTS POSITION ON REEL CHANGE AS PER ECN 22-169 | B |
| 9.03.21 | WAS 15,000 PCS ON CARDBOARD CHANGE AS PER ECN 21-101 | A |
| DATE | DESCRIPTION | REV. |

| | | | |
|--|----------------------------|--------------|---------------------|
| KEYSTONE ELECTRONICS CORP. | | | |
| www.keyelco.com • NEW HYDE PARK, NY 11040 • Tel (516) 328-7500 | | | |
| PART NAME PC QUICK TERMINAL ON CONTINUOUS REEL | | | |
| MATERIAL AS NOTED | | | |
| FINISH AS NOTED | | DRN BY NT | DATE 9.17.18 |
| | | APP'D LN | SCALE 2X, 1X |
| TOLERANCES DECIMAL ANGULAR | INCH [MM] ±.005 [±0.13] | CODE C | DWG NO. 1289-STR |
| UNLESS OTHERWISE SPECIFIED | | | |