

THIS DOCUMENT IS THE PROPERTY OF
KEYSTONE ELECTRONICS CORP. AND
SHALL NOT BE REPRODUCED, DISTRIBUTED
OR USED AS A BASIS FOR MANUFACTURE
WITHOUT PRIOR WRITTEN PERMISSION
FROM KEYSTONE ELECTRONICS CORP.

ACTUAL SIZE

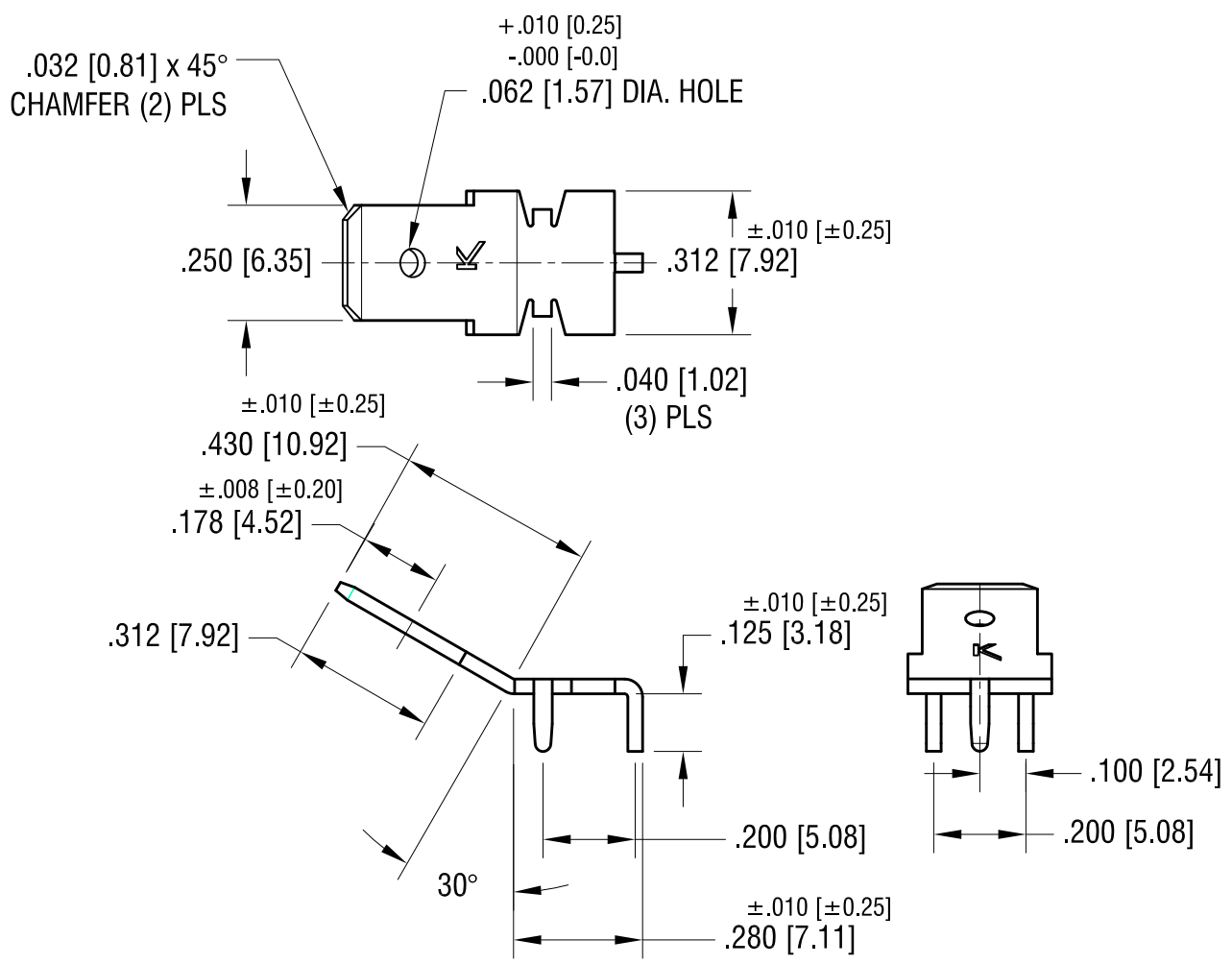
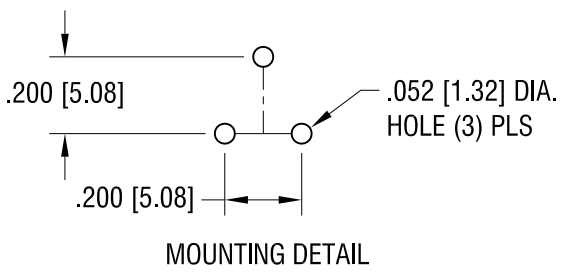
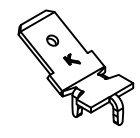

| | | | | | |
|---------|--------------------------|------|---|-----------|---------------------------|
| | | | KEYSTONE ELECTRONICS CORP. | | |
| | | | www.keyelco.com • ASTORIA, N.Y. 11105-2017 • Tel (718) 956-8900 | | |
| 8.30.12 | CHANGE AS PER ECN 12-121 | D | PART NAME .250 [6.35] PC QUICK-FIT TERMINAL | | |
| 5.16.12 | CHANGE AS PER ECN 12-065 | C | MATERIAL .032 [0.81] TH'K BRASS | | |
| 6.10.09 | CHANGE AS PER ECN 09-065 | B | FINISH MATTE TIN PLATE | | DRN BY BOONE DATE 7.28.95 |
| 1.15.08 | CHANGE AS PER ECN 08-050 | A | | | APP'D LN SCALE 2.5X |
| DATE | DESCRIPTION | REV. | TOLERANCES INCH [MM] DECIMAL ±.005 [±0.15] ANGULAR ± 1° UNLESS OTHERWISE SPECIFIED | CODE C | DWG NO. 4908 |